

Sheet Revisions		
Date	Description	Initials

Sheet Revisions		
Date	Description	Initials

Project/Land Survey Control Diagram			
Title Sheet			
Project Number: FBR R200-266			
Project Location: BRIDGE REPLACEMENT			
I-17-X - US HIGHWAY 24			
Project Code:	Last Mod. Date	Subset	Sheet No.
23559	12-7-2020	3.01 of 3.02	3.01

# DEPARTMENT OF TRANSPORTATION STATE OF COLORADO

## PROJECT / LAND SURVEY CONTROL DIAGRAM

SHEET NO.	INDEX OF SHEETS
3.01	(1) Title Sheet
3.02	(1) Project Control Diagram
(2) Total Sheets	

### US HIGHWAY NO 24 SECTIONS 25 & 36, T-13-S, R-68-W SIXTH PRINCIPAL MERIDIAN EL PASO COUNTY

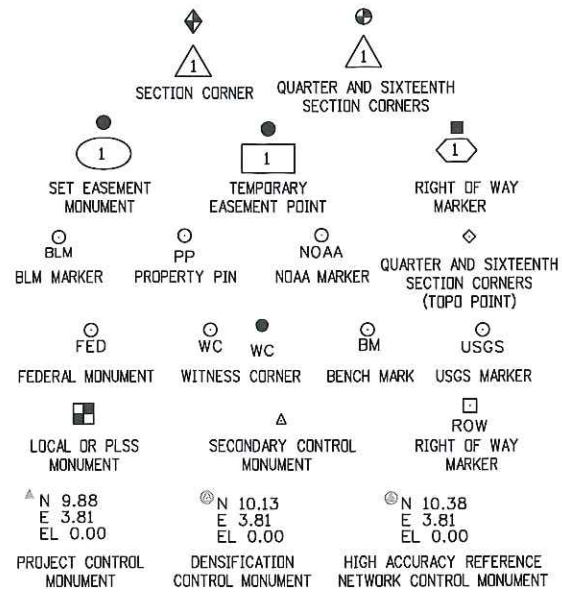

Note: For a complete listing of symbolology used within this set of plans, please refer to the M-100-1 Standard Symbols of the Colorado Department of Transportation M&S Standards Publication. Existing features are shown as screened weight (gray scale). Proposed or new features are shown as full weight without screening.



Typical Control Monument Cap  
Not to Scale

▲ CM-MP - Control Point Monuments set by CDOT. They are CDOT Type 2 monuments, a 3 1/4" dia. aluminum control monument cap (as shown) on a 3' x 3/4" dia. aluminum security rod on a 3' x 3/4" dia. smooth aluminum rod.

**General Notes:**

1. This Project Control Diagram is not a boundary survey of the adjoining property and is prepared for the Colorado Department of Transportation purposes only.
2. This plan set is subject to change and may not be the most current set. It is the user's responsibility to verify with CDOT that this set is the most current. The information contained on the attached drawing is not valid unless this copy bears an original signature of the Professional Land Surveyor hereon named.
3. Refer to the M-629-1 Survey Monuments of the Standard Plans found in The Colorado Department of Transportation, M & S Standards for typical survey monument descriptions.

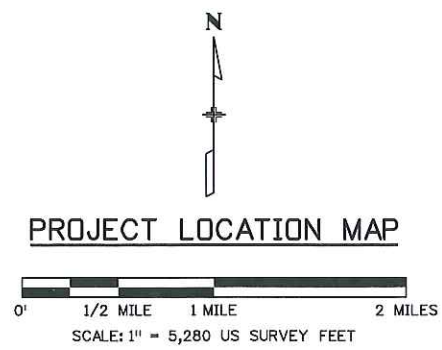
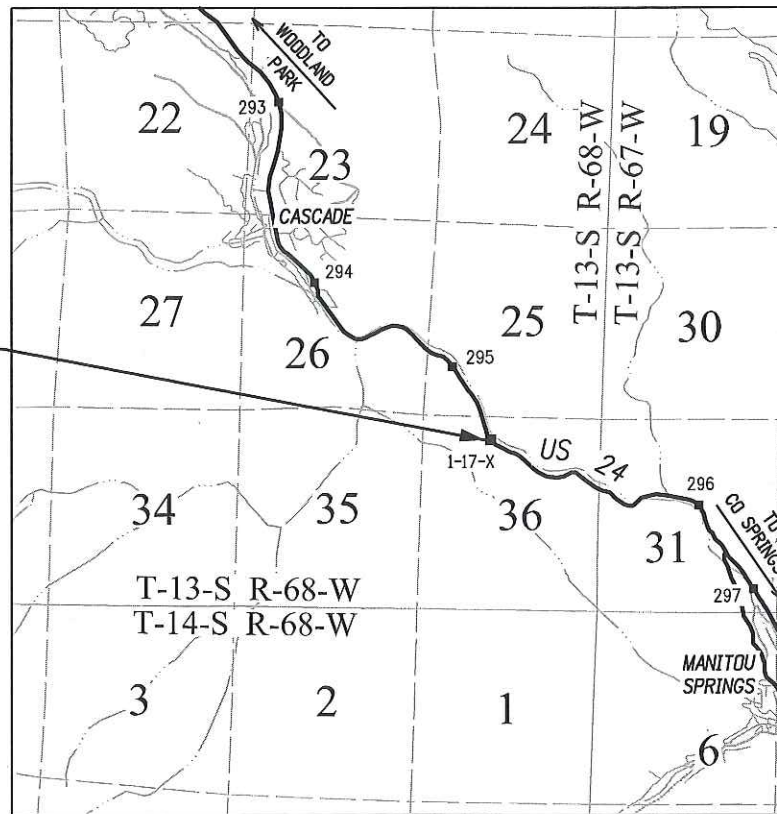

The control for this project is part of a larger control network established for CDOT for Project NH 0242-056. The control was checked for accuracy.

Basis of Bearings: Bearings used in the calculations of coordinates are based on a grid bearing of S43°16'22"E from Control Point 9581 (a CDOT Type II Control Monument - MP 295.81) to Control Point 9586 (a CDOT Type II Control Monument - MP 295.86). Both monuments are marked appropriately for their milepost location. Coordinates are based on existing control established by the Colorado Department of Transportation for Project No: NH 0242-056 and were verified for this project.

Basis of Elevations: Project elevations are based on Control Point 9581 (a CDOT Type II Control Monument - MP 295.81) established during a prior project.

COORDINATE DATUM: Project coordinates are modified Colorado State Plane Central Zone (502) NAD '83/(11) coordinates. The combined elevation/scale factor used to modify the coordinates from state plane to project coordinates is 1.0003911480. The resulting project coordinates are truncated by 1,000,000 in the Northing and 3,000,000 in the Easting after converting from state plane coordinates to project coordinates.

Project Coordinates Northing US Survey Feet = (State Plane Coordinate Northing(ft) \* 1.0003911480).  
 Project Coordinates Easting US Survey Feet = (State Plane Coordinate Easting(ft) \* 1.0003911480).

NOTICE: According to Colorado law you must commence any legal action based upon any defect in this survey within three years after you first discover such defect. In no event may any action based upon any defect in this survey be commenced more than ten years from the date of the certification shown hereon.

**SURVEYOR STATEMENT (Project Control Diagram)**

I, Lorelei A. Ward, a professional land surveyor licensed in the State of Colorado, do hereby state to the Colorado Department of Transportation this Project Control Diagram was prepared and the field survey it represents was performed under my responsible charge and, based upon my knowledge, information and belief is in accordance with applicable standards of practice defined by Colorado Department of Transportation publications. This statement is not a guaranty or warranty, either expressed or implied.

PLS No. 34982



Sheet Revisions		
Date	Description	Initials

Sheet Revisions		
Date	Description	Initials

Project Control Diagram			
Plan Sheet			
Project Number: FBR R200-266			
Project Location: BRIDGE REPLACEMENT			
I-17-X - US HIGHWAY 24			
Project Code:	Last Mod. Date	Subset	Sheet No.
23559	11-10-2020	3.02 of 3.02	3.02

**DEPARTMENT OF TRANSPORTATION  
 STATE OF COLORADO  
 PROJECT CONTROL DIAGRAM  
 US HIGHWAY 24  
 SECTION 25 & 36, T-13-S R-68-W, 6TH PM  
 EL PASO COUNTY**

General Notes:

1. This Project Control Diagram is not a boundary survey of the adjoining property and is prepared for the Colorado Department of Transportation purposes only.
2. This plan set is subject to change and may not be the most current set. It is the user's responsibility to verify with CDOT that this set is the most current. The information contained on the drawing is not valid unless this copy bears an original signature of the Professional Land Surveyor hereon named.
3. Refer to the M-629-1 Survey Monuments of the Standard Plans found in The Colorado Department of Transportation, M & S Standards for typical survey monument descriptions.

PROJECT COORDINATE TABLE				
Point No	Project Coordinates		Elev(ft) (NAVD88)	Description
	Northing(ft)	Easting(ft)		
701	384,841.56	156,576.63	7,138.93	1.5" ALUM CAP - "DEA INC CONTROL"
702	382,836.89	157,783.07	7,031.53	#4 REBAR W/DIMPLE IN CENTER
9449	382,896.40	157,898.03	7,030.37	CDOT TYPE II CONTROL MONUMENT - "MP 294.49"
9450	382,776.53	157,646.33	7,035.95	CDOT TYPE II CONTROL MONUMENT - "MP 294.50"
9497	384,994.93	156,072.27	7,157.70	CDOT TYPE II CONTROL MONUMENT - "MP 294.97"
9581	381,949.07	158,856.89	6,992.63	CDOT TYPE II CONTROL MONUMENT - "MP 295.81"
9586	381,749.84	159,044.45	6,984.54	CDOT TYPE II CONTROL MONUMENT - "MP 295.86"

GEODETIC COORDINATE TABLE									
Point No	Geodetic Coordinates NAD-83(2011)		Elip Height (NAVD88)	Ortho Height (NAVD88)	Mapping Angle	Grid Scale Factor	NAD 83(2011) Zone 0502		Description
	Latitude(N)	Longitude(W)					SP Northing	SP Easting	
9449	38°52'54.82132"	-104°56'58.73683"	6,979.10	7,030.37	-6°02'24.7"	1.001302496	1,382,355.69	3,156,663.30	CDOT TYPE II CONTROL MONUMENT - "MP 294.49"
9450	38°52'53.65194"	-104°57'01.92776"	6,984.69	7,035.95	-6°02'26.5"	1.001302628	1,382,235.87	3,156,411.70	CDOT TYPE II CONTROL MONUMENT - "MP 294.50"
9497	38°53'15.66507"	-104°57'21.65812"	7,106.64	7,157.70	-6°02'40.3"	1.001291186	1,384,453.40	3,154,838.25	CDOT TYPE II CONTROL MONUMENT - "MP 294.97"
9581	38°52'45.40335"	-104°56'46.68849"	6,941.26	6,992.63	-6°02'16.7"	1.001306620	1,381,408.73	3,157,621.78	CDOT TYPE II CONTROL MONUMENT - "MP 295.81"
9586	38°52'43.42353"	-104°56'44.33288"	6,933.14	6,984.54	-6°02'15.1"	1.001307499	1,381,209.58	3,157,809.28	CDOT TYPE II CONTROL MONUMENT - "MP 295.86"

Combined Scale Factor: 1.0003911480  
 Northing Truncation: 1,000,000  
 Easting Truncation: 3,000,000  
 All values are US Survey Feet  
 Elevation is NAVD 88

Basis of Bearings: Bearings used in the calculations of coordinates are based on a grid bearing of S43°16'22"E from Control Point 9581 (a CDOT Type II Control Monument - MP 295.81) to Control Point 9586 (a CDOT Type II Control Monument - MP 295.86). Both monuments are marked appropriately for their milepost location. Coordinates are based on existing control established by the Colorado Department of Transportation for Project No: NH 0242-056 and were verified for this project.

Coordinate Datum: Project coordinates are modified Colorado State Plane Central Zone (0502) NAD 83 (2011) coordinates. The combined elevation/scale factor used to modify state plane to project coordinates is 1.0003911480. The resulting project coordinates are truncated by 1,000,000 in the Northing and 3,000,000 in the Easting after converting from state plane coordinates to project coordinates.

Project Coordinates Northing US Survey Feet = (State Plane Coordinate Northing \* 1.0003911480 - 1,000,000)  
 Project Coordinates Easting US Survey Feet = (State Plane Coordinate Easting \* 1.0003911480 - 3,000,000)

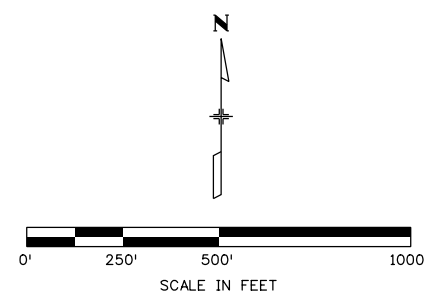
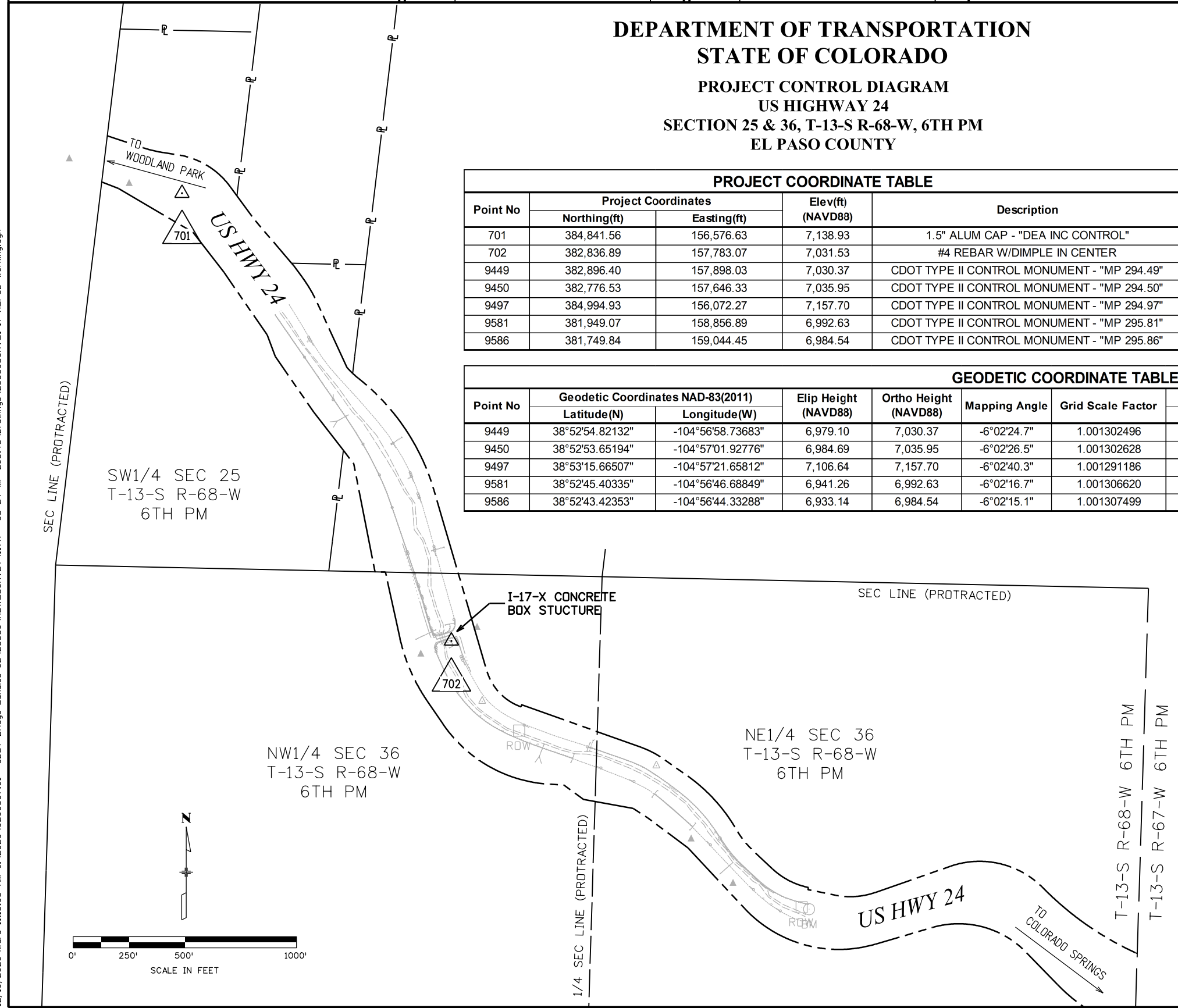

12/16/2020 11:13:03 AM J:\2020\0200567.01 - CDOT Bridge Bundles 02\23559\RDW\_SURVEY\I17X - US 24 MP 295.45\Drawings\23559SURV\_I17-X\_PCD\_working.dgn